

**Subject: Specialite™ Patient Light (P645), Integris® 1000 Patient Light (P696IL), Integris® B Lite Rail (P2003B), First Impression® Series Headwall (P780D) Safety Cutoff Switch Inspection and Replacement Instructions**

---

**Introduction**

This document describes the inspection and replacement for safety cutoff switches found in the following products: Specialite™ Patient Light (P645), Integris® 1000 Patient Light (P696IL), Integris® B Lite Rail (P2003B), and First Impression® Series Headwall (P780D).

Tools required:   Phillips head screwdriver                               7/16" wrench  
                          Flashlight                                                                Needle nose pliers

Parts required:   (For quantities see table 1 on page 1)   34069 Safety switch

Reference Documents: *Integris® Patient Light Service Manual (man139)*  
                              *The Specialite™ Service Manual (man046)*  
                              *The First Impression® Series Service Manual (man006)*

**Table 1. Safety Cutoff Switches Needed According to Product**

<b>Product Number</b>	<b>Product Description</b>	<b>Number of Switches Needed</b>
P645	Specialite™ Patient Light	2
P696IL	Integris® 1000 Patient Light	4
P2003B	Integris® B Lite Rail	4
P780D	First Impression® Series Headwall	4

There are three different procedures contained in these instructions, one for each product.

- For Specialite™ Patient Lite (P645), go to “Specialite™ Patient Light (P645)” on page 2.
- For Integris® 1000 Patient Light (P696IL) or Integris® B Lite Rail (P2003B), go to “Integris® 1000 Patient Light (P696IL) or Integris® B Lite Rail (P2003B)” on page 5.
- For First Impression® Series Headwall (P780D), go to “First Impression® Series Headwall (P780D)” on page 9.

## Specialite™ Patient Light (P645)

Inspect the Specialite™ Patient Lights (P645) safety cutoff switches and replace them, if the incorrect 15 amp switch is installed.

### Inspection

1. Rotate the indirect light (A) to the exam light position (see figure 1 on page 3).
2. Locate the UL/serial number label (B).
3. Read the handwritten date on the UL/serial number label (B).
4. If the date is either 5-02 or 6-02, record the serial number and continue the procedure. Otherwise, the safety cutoff switches are correct, and there is no need to inspect them.



### **SHOCK HAZARD:**

Disconnect all electrical power to the system before working on it. Failure to do so could result in personal injury or equipment damage.

5. Locate the appropriate breaker or breakers for the system being inspected.
6. Ensure that all applicable breakers are turned to the OFF position, and tagged OUT.

### **NOTE:**

For clarity, the graphic does not show the indirect light in the remaining steps.

7. Remove and save the screws (C) securing the cover (D) to the center housing (E).
8. Remove and save the cover (D).
9. Visually inspect the two safety cutoff switches (F).
  - a. If the switches (F) have rivets (G) securing their housings together, they are the correct 20 amp switches.

Leave them installed, and go to step 18 on page 4.

- b. If either switch (F) does not have rivets (G) it is the incorrect 15 amp switch; replace it. See “Replacement” on page 4.

**Figure 1. Specialite™ Patient Light (P645) Switch Inspection and Replacement**

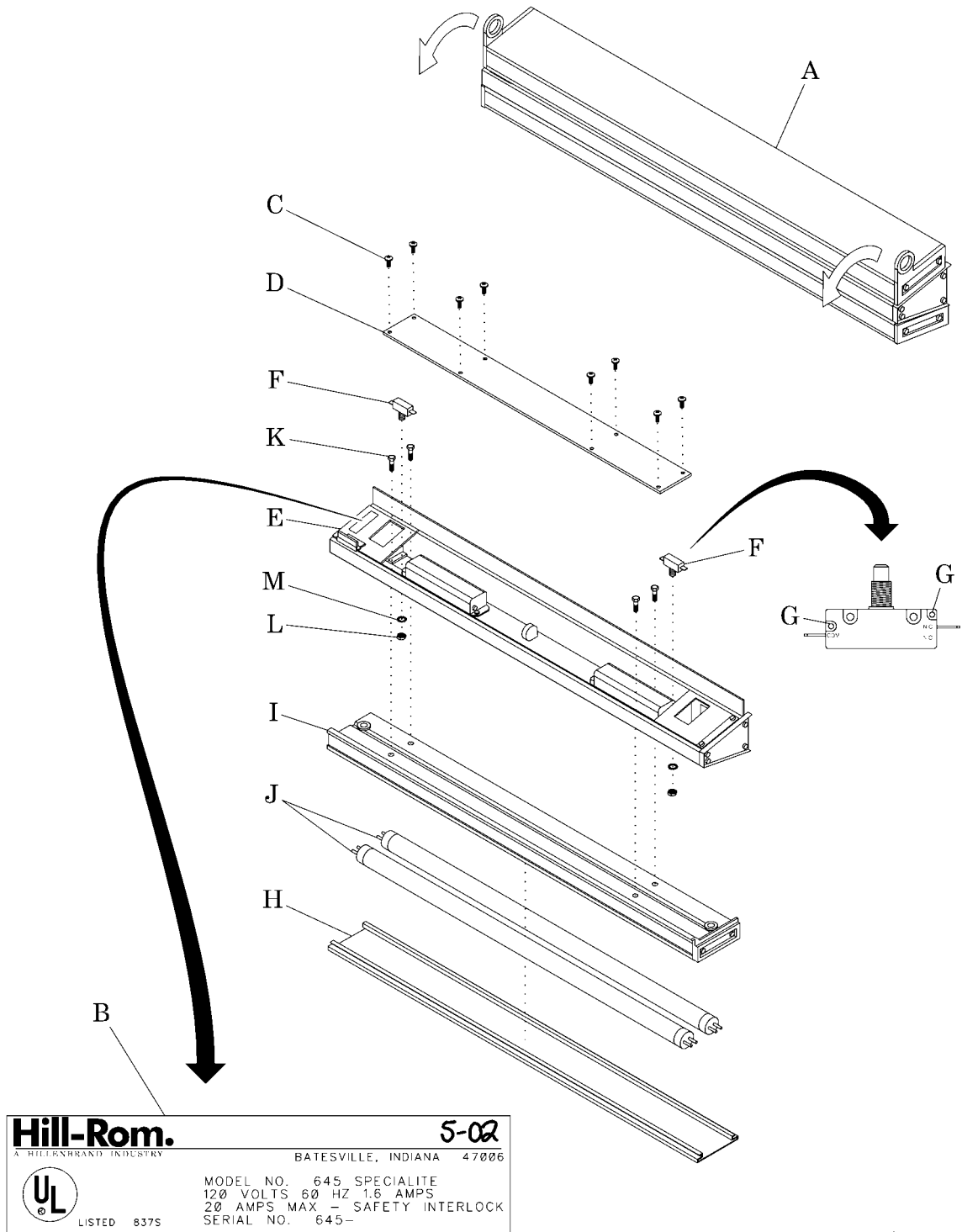

i629\_002

## Replacement

Replacement is only necessary if either switch (F) is rated for less than 20 amps (does not have rivets (G)).

1. Snap the lens (H) out of the bottom of the read light assembly (I) by squeezing the edges.
2. Save the lens (H).
3. Remove and save the fluorescent lights (J) from the read light assembly (I).
4. Remove and save the bolts (K) mounting the assembly (I) to the center housing (E).
5. Support the read light assembly (I) so its weight does not pull on any wires.
6. Remove and save the nuts (L) and washers (M) securing the switches (F) to the center housing (E).
7. Pull the switches (F) out of the center housing (E).
8. Note the position of the wires connected to the switches (F).
9. Disconnect the wires from the switches (F).
10. Remove and discard the old switches (F).
11. Install the new 25 amp switches (F).
12. Connect the wires to the switches (F) in their original positions.
13. Secure the switches (F) to the center housing (E) using the nuts (L) and washers (K).
14. Secure the read light assembly (I) using the bolts (K) to the center housing (E).
15. Install the fluorescent lights (J) into the read light assembly (I).



### **WARNING:**

Securely seat fluorescent lights in the sockets. Failure to do so could cause personal injury or equipment damage.

16. Ensure the fluorescent lights (J) are securely seated in the sockets.
17. Snap the lens (H) into the read light assembly (I).
18. Secure the cover (D) to the center housing (E) using the screws (C).
19. Rotate the indirect light (A) to its normal position.
20. Turn all applicable breakers to the ON, and remove the OUT tags.
21. Test the safety cutoff switches to ensure proper operation.

## **Integris® 1000 Patient Light (P696IL) or Integris® B Lite Rail (P2003B)**

### **Inspection**

Inspect the Integris® 1000 Patient Light (P696IL) and Integris® B Lite Rail (P2003B) safety cutoff switches and replace them, if the incorrect 15 amp switch is installed.

1. Rotate the indirect light (A) to the exam light position (see figure 2 on page 6).
2. Locate the UL/serial number label (B).
3. Read the handwritten date on the UL/serial number label (B).
4. If the date is either 5-02 or 6-02, record the serial number and continue the procedure. Otherwise, the safety cutoff switches are correct, and there is no need to inspect them.



#### **SHOCK HAZARD:**

Disconnect all electrical power to the system before working on it. Failure to do so could result in personal injury or equipment damage.

5. Locate the appropriate breaker or breakers for the system being inspected.
6. Ensure that all applicable breakers are turned to the OFF position, and tagged OUT.

#### **NOTE:**

For clarity, the graphic does not show the indirect light in the remaining steps.

#### **NOTE:**

The graphic does not show the Integris® B Lite Rail end caps.

7. Remove and save the screws (C) securing the center cover (D) to the center housing (E).
8. Remove and save the center cover (D).
9. Note the positions of the ground straps (F).
10. Remove and save the screws (G) securing both of the end covers (H) to the center housing (E).
11. Remove and save the end covers (H).
12. Visually inspect the four safety cutoff switches (I).
  - a. If the switches (I) have rivets (J) securing the housings together, they are 20 amp switches.

Leave them installed, and go to step 20 on page 8.
13. If any switch (J) does not have rivets (K), it is the incorrect 15 amp switch; replace it. See “Replacement” on page 7.

**Figure 2. Integris® 1000 Patient Light (P696IL) and Integris® B Lite Rail (P2003B) Switch Inspection and Replacement**

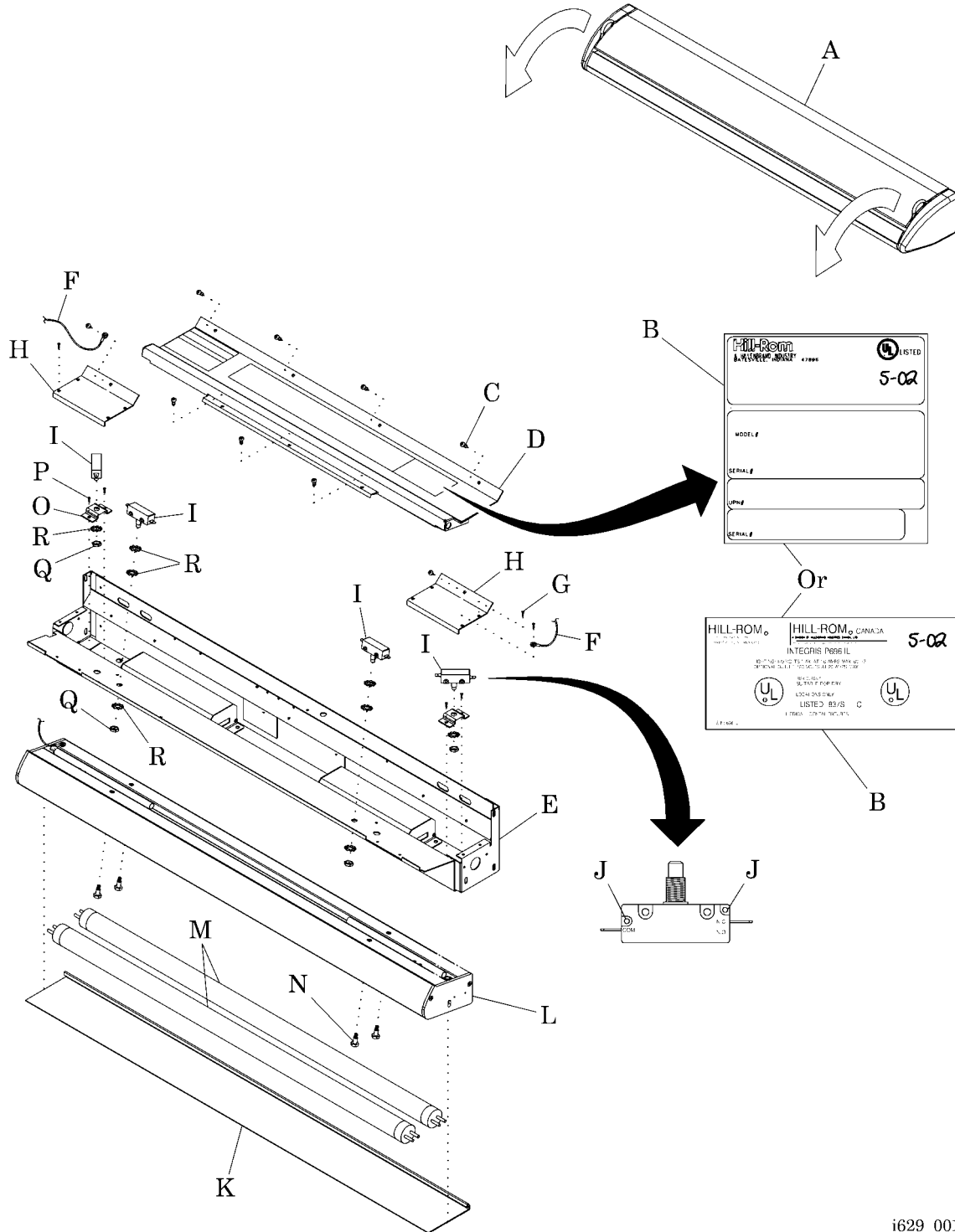

i629\_001

## Replacement

Replacement is only necessary if any switch (I) is rated for less than 20 amps (does not have rivets (J)).

1. Snap the lens (K) out of the bottom of the read light assembly (L) by squeezing the edges.
2. Save the lens (K).
3. Remove and save the fluorescent lights (M) from the read light assembly (L).
4. Remove and save the bolts (N) securing the read light assembly (L) to the center housing (E).
5. Support the read light assembly (L) so its weight does not pull on any wires.
6. Note the position of the wires connected to the switches (I).
7. Disconnect the wires.
8. If applicable, remove the screws (P) securing the switch brackets (O) to the center housing (E).
9. Save the screws (P) and the brackets (O).
10. Remove and save the nuts (Q) and washers (R) from the switches (I).
11. Remove and discard the switches (I).
12. Install the new 25 amp switches (I).
13. Connect the wires to the switches (I) in their original positions.
14. If the switch was mounted to a bracket (O), do the following:
  - Secure the switch (I) to the bracket (O) using the nuts (Q) and washers (R).
  - Secure the bracket (O) to the center housing (E) using the screws (P).
15. If the switch was not mounted to a bracket (O), secure the switch (I) to the center housing (E) using the nuts (Q) and washers (R).
16. Secure the read light assembly (L) to the center housing (E) using the bolts (N).
17. Install the fluorescent lights (M) in the read light assembly (L).



**WARNING:**

Securely seat fluorescent lights in the sockets. Failure to do so could cause personal injury or equipment damage.

18. Ensure the fluorescent lights (M) are securely seated in the sockets.
19. Snap the lens (K) into the read light assembly (L).
20. Secure the center cover (D) to the center housing (E) using the screws (C).
21. Secure the end covers (H) to the center housing (E) using the screws (G).
22. Ensure the ground straps (F) are securely fastened in their original positions.
23. Rotate the indirect light (A) to its normal position.
24. Turn all applicable breakers to the ON position, and remove the OUT tags.
25. Test the safety cutoff switches (I) to ensure proper operation.

## **First Impression® Series Headwall (P780D)**

Inspect the First Impression® Series Headwall (P780D) safety cutoff switches and replace them, if the incorrect 15 amp switch is installed.

### **Inspection of the Indirect Light Safety Cutoff Switches**

1. Locate the UL/serial number label (A) underneath the left-hand side of the headwall (B).
2. Read the handwritten date on the UL/serial number label (A).
3. If the date is either 5-02 or 6-02, record the serial number and continue the procedure. Otherwise, the safety cutoff switches are correct, and there is no need to inspect them.



#### **SHOCK HAZARD:**

Disconnect all electrical power to the system before working on it. Failure to do so could result in personal injury or equipment damage.

4. Locate the appropriate breaker or breakers for the system being inspected.
5. Ensure that all applicable breakers are turned to the OFF position, and tagged OUT.

#### **NOTE:**

These steps are applicable for both the left-hand and right-hand sides of the headwall.

6. Remove and save the screws (C) securing the indirect light cover (D) to the indirect light housings (E).
7. Remove and save the covers (D).
8. Visually inspect the two safety cutoff switches (F).
  - a. If the switches (F) have rivets (G) securing the housings together, they are 20 amp switches.

Leave them installed, and go to step 8 on page 11.

9. If either switch (F) does not have rivets (G), it is the incorrect 15 amp switch; replace the switch. See “Replacement of the Indirect Light Safety Cutoff Switches” on page 11.

**Figure 3. First Impression® Series Headwall (P780D) Indirect Lighting Switch Inspection and Replacement**

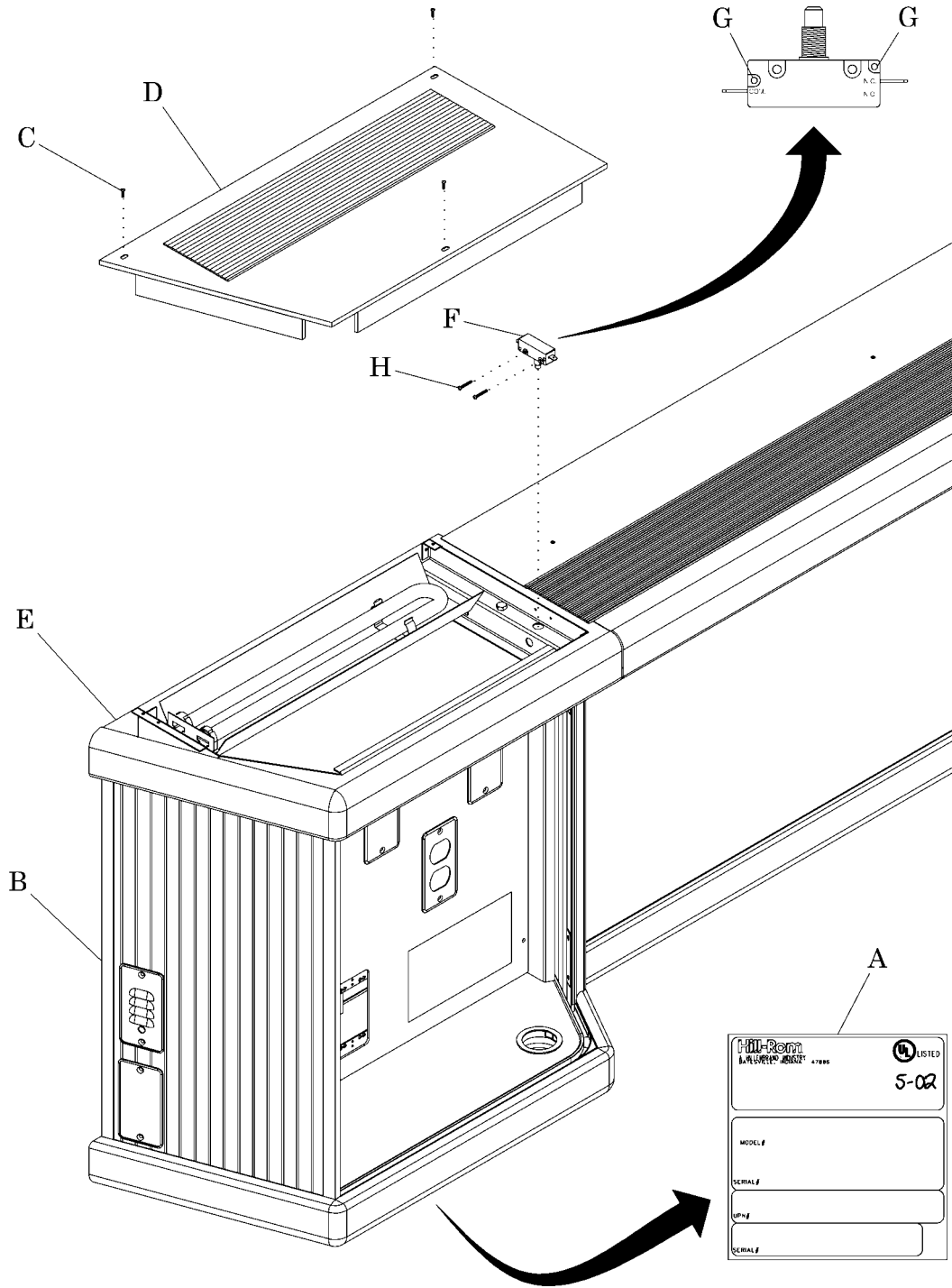

i629\_003

### **Replacement of the Indirect Light Safety Cutoff Switches**

1. Note the position of the wires connected to the switches (F).
2. Disconnect the wires.
3. Remove and save the screws (H) from the switches (F).
4. Remove and discard the switches (F).
5. Install the new 25 amp switches (F).
6. Secure the switches (F) to the indirect light housing (E) using the screws (H).
7. Connect the wires to the switches (F) in their original positions.
8. Secure the cover (D) to the indirect light housing (E) using the screws (C).
9. Go to “Inspection of the Floating Bottom Assembly Safety Cutoff Switches” on page 11.

### **Inspection of the Floating Bottom Assembly Safety Cutoff Switches**



#### **SHOCK HAZARD:**

Disconnect all electrical power to the system before working on it. Failure to do so could result in personal injury or equipment damage.

1. Ensure that all applicable breakers are turned to the OFF position, and tagged OUT.
2. Remove and save the screws (I) securing the tambour trim (J) to the headwall (B) (see figure 4 on page 12).
3. Remove and save the tambour trim (J).
4. Remove and save the tambour (K).

#### **NOTE:**

If any receptacles are mounted in the tambour, remove them.

5. Open the center cover (L) by pushing a screwdriver into the lock (M) and pulling out on the center cover (L).
6. Remove the center cover (L) by rotating it up approximately 60° until the hanger brackets (N) disengage, then push the center cover (L) upwards and off.

#### **NOTE:**

You may have to push the center cover slightly into the read light assembly to remove it.

**Figure 4. Panel Removal**

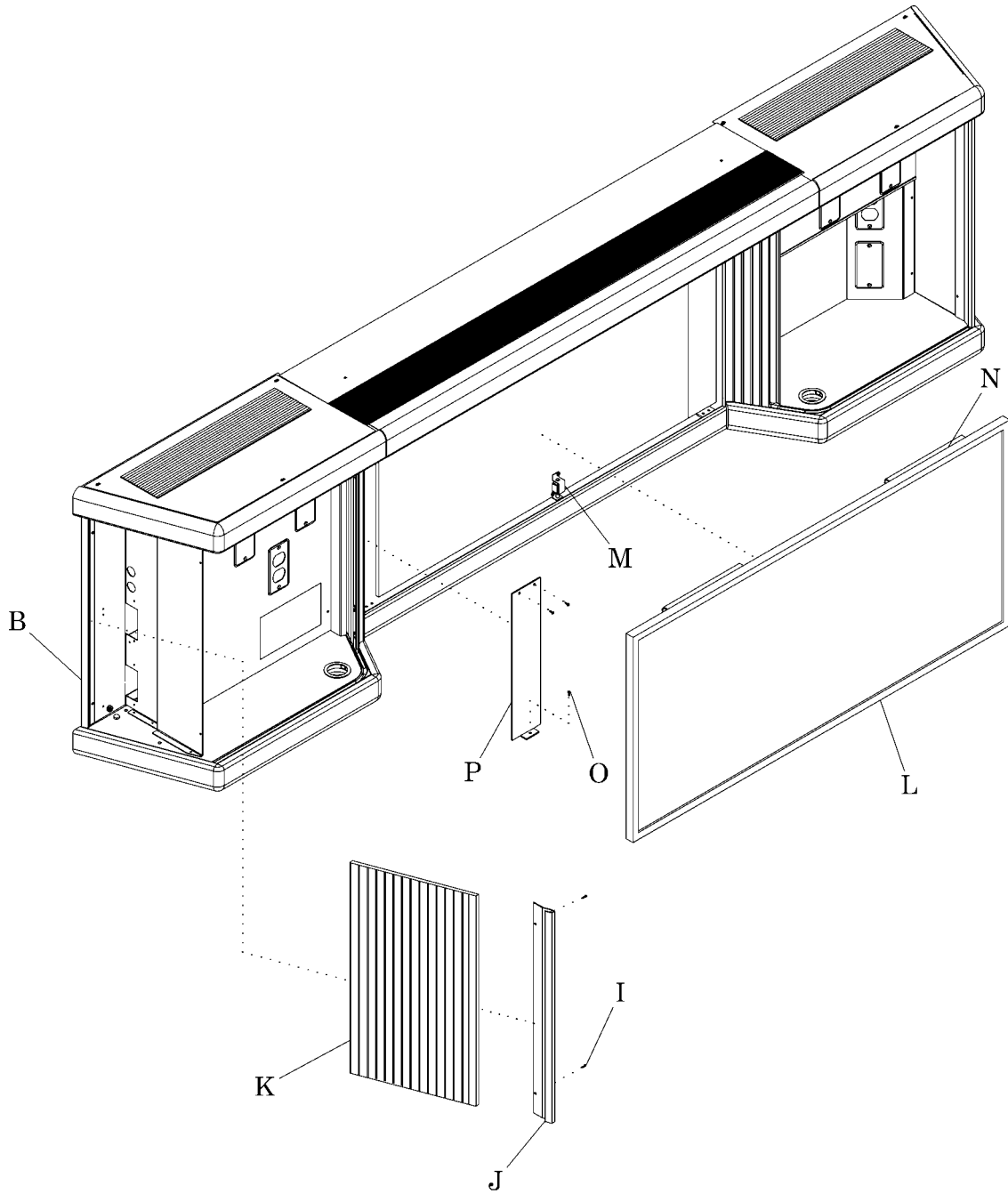

i629\_004

7. Save the center cover (L).
8. Remove and save the screws (O) securing both of the end panels (P) to the headwall (B).
9. Remove and save the end panels (P).
10. Remove and save the screws (R) securing the outside portion of the floating bottom assembly (Q) to the headwall (B). See View S (see figure 5 on page 14).
11. Loosen the screws (T) securing the inside portion of the floating bottom assembly (Q) to the headwall (B). See View U.
12. Pull the floating bottom assembly (Q) down from the headwall (B) and shine a flashlight (V) into the space between them (see figure 6 on page 15).
13. Visually inspect the two safety cutoff switches (F). See View W.
  - a. If the switches (F) have rivets (G) securing the housings together, they are 20 amp switches.

Leave them installed, and go to step 14 on page 18.

**NOTE:**

The switches are almost covered by a housing, but if they have rivets the light reflects off of them.

14. If either switch (F) does not have rivets (G), it is the incorrect 15 amp switch; replace the switch. See “Replacement of the Floating Bottom Assembly Safety Cutoff Switches” on page 16.

**Figure 5. Mounting Screw Removal**

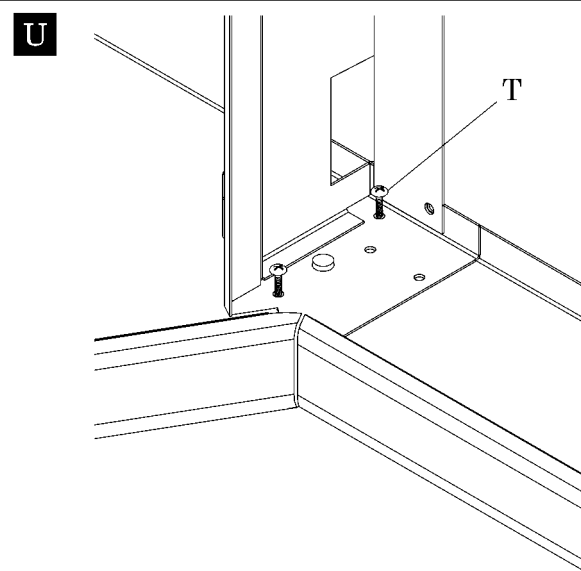
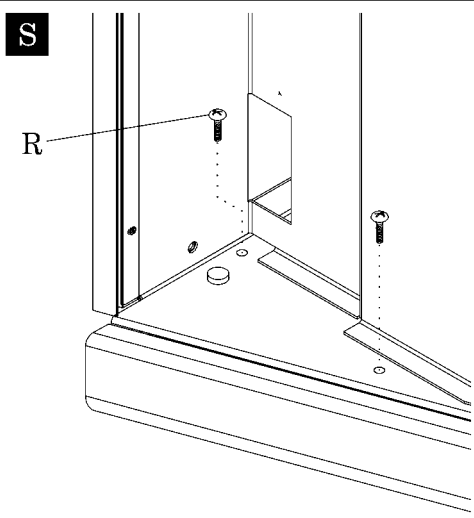
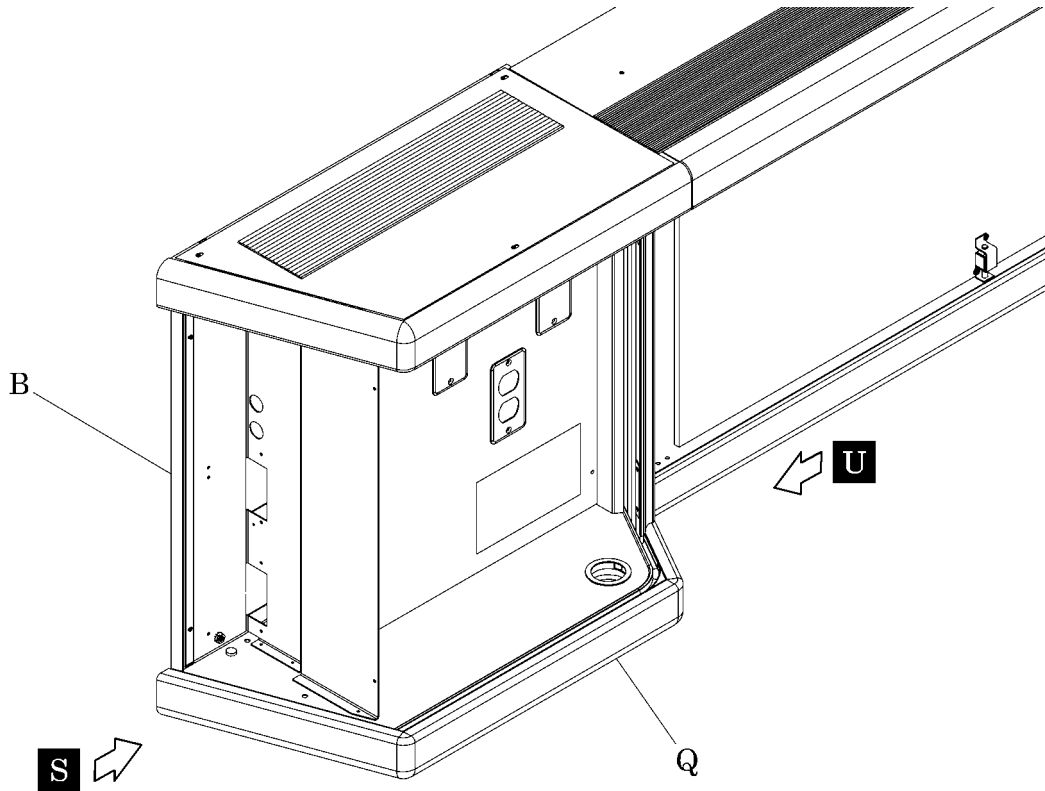

i629\_005

**Figure 6. Floating Bottom Assembly Switch Inspection**

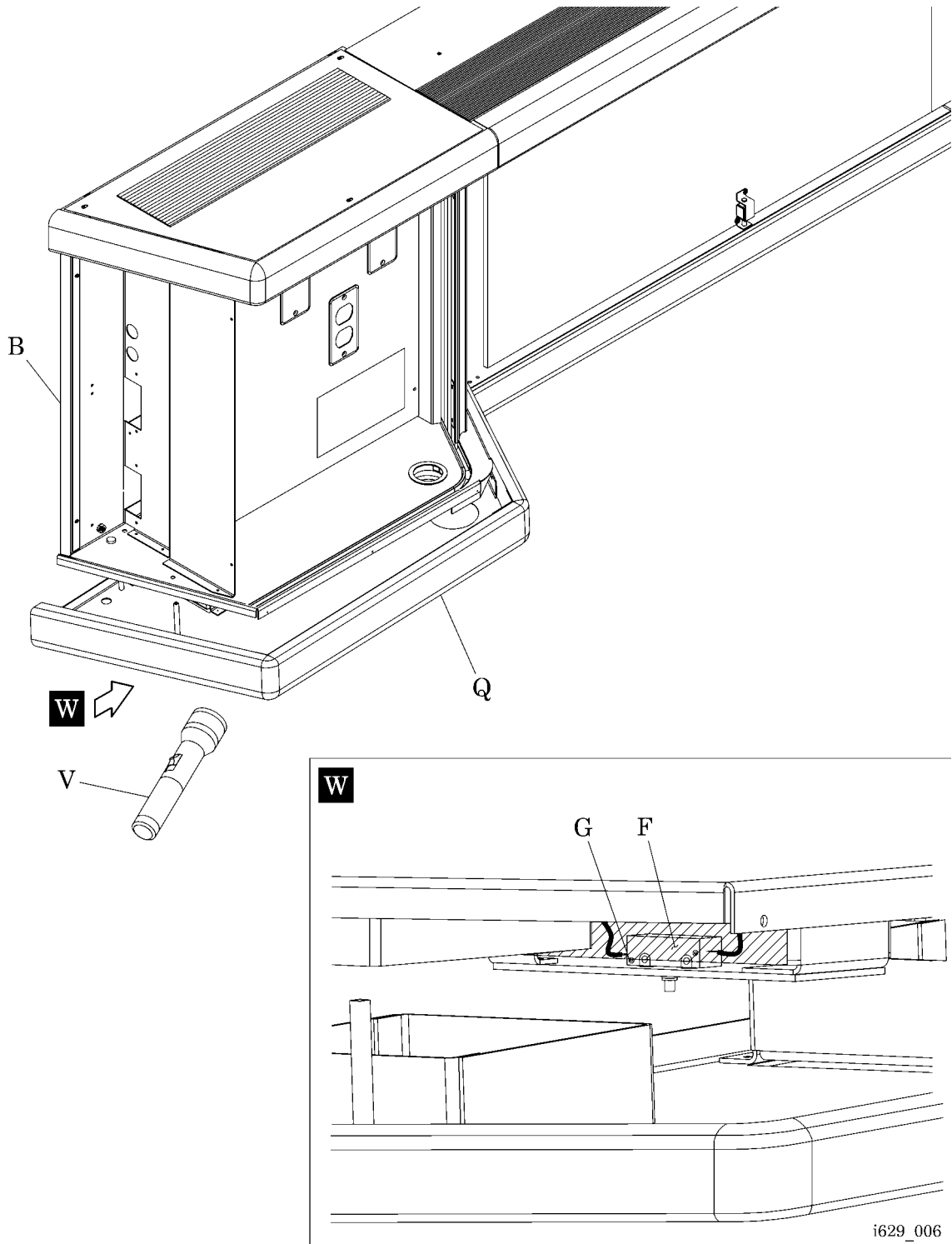

## **Replacement of the Floating Bottom Assembly Safety Cutoff Switches**

Two people are required for the replacement of the floating bottom assembly (Q) safety cutoff switches.

1. With one person on each end of the floating bottom assembly (Q), remove and save the screws (R) and (T) securing it to the headwall (B) (see figure 5 on page 14).
2. Support both ends of the floating bottom assembly (Q) so its weight does not pull on any wires (see figure 7 on page 17).
3. Remove and save the screws (X) securing the switch brackets (Y) to the headwall (B).
4. Note the position of the wires connected to the switches (F).
5. Disconnect the wires from the switches (F).
6. Remove and save the nuts (Z) and washers (AA) from the switches (F).
7. Remove and discard the switches (F).
8. Install the new 25 amp switches (F).
9. Position the washers (AA) onto the switches (F).
10. Secure the switches (F) onto the brackets (Y) using the nuts (Z) and washers (AA).
11. Connect the wires to the switches (D) in their original positions.
12. Secure the brackets (Y) to the headwall (B) using the screws (X).
13. Lift and support both sides of the floating bottom assembly (Q) in its installed position.

**Figure 7. Floating Bottom Assembly Switch Replacement**

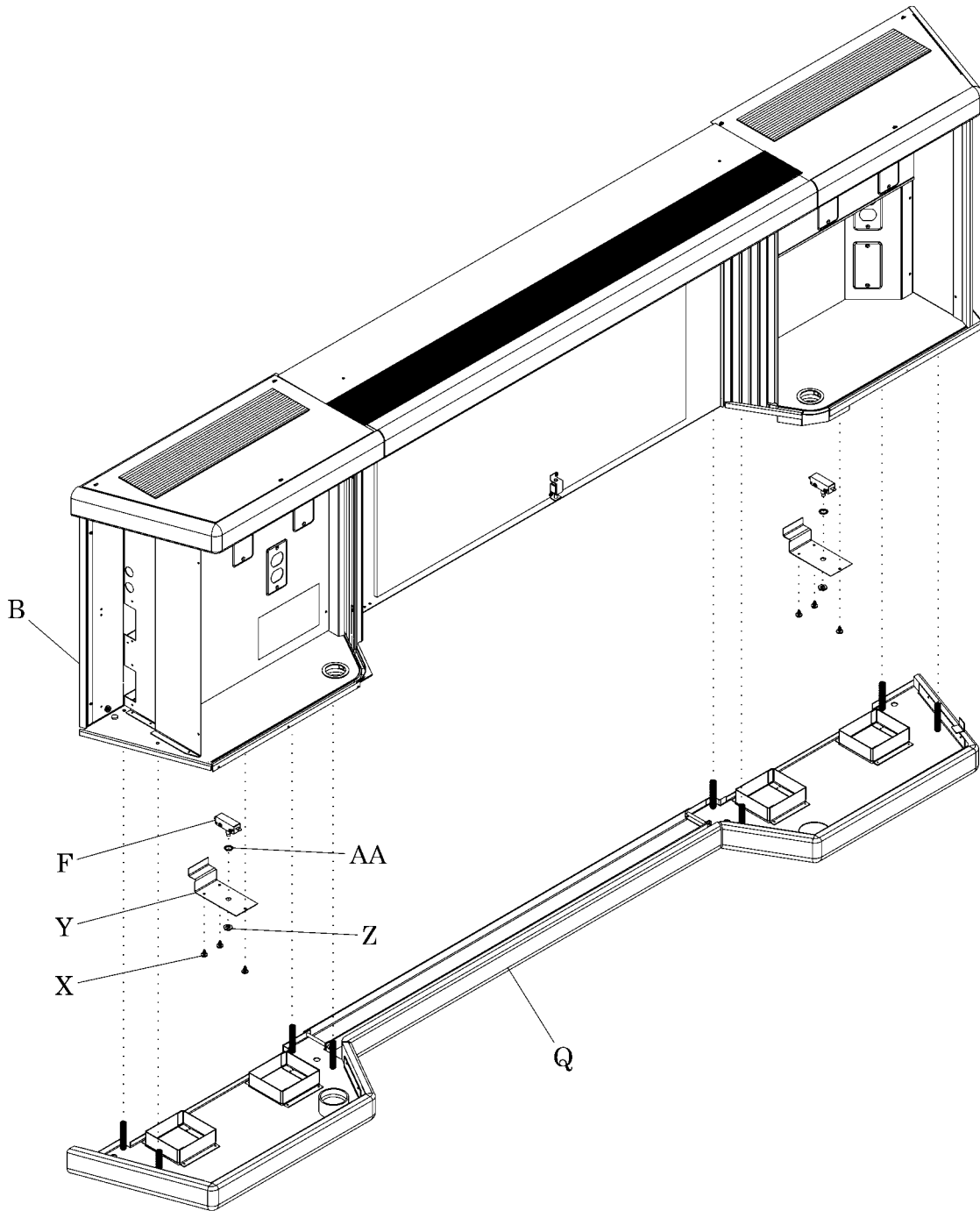

i629\_007

14. Secure the floating bottom assembly (Q) to the headwall (B) using the screws (R) and (T) (see figure 5 on page 14).
15. Secure the end panels (P) to the headwall (B) using the screws (O) (see figure 4 on page 12).
16. Install the center cover (L) by rotating it to 60° and engaging the hanger brackets (N) onto the headwall (B).

**NOTE:**

You may have to push the center cover slightly into the read light assembly to install it.

17. Lock the center cover (L) into place.

**NOTE:**

If any receptacles were mounted in the tambour, install them.

18. Install the tambour (K).
19. Secure the tambour trim (J) onto the headwall (B) with the screws (I).
20. Turn all applicable breakers to the ON position, and remove the OUT tags.
21. Test the safety cutoff switches in both indirect light housings (E) (see figure 3 on page 10) and the floating bottom assembly (Q) (see figure 7 on page 17) to ensure proper operation.